



# HEST status and commissioning plan

May 22nd, 2018  
m.sapinski@gsi.de

- HADES beamline:
  - SEM detectors will be installed next week,
  - 2 broken valves need to be replaced, a piece of beam pipe in production, when?
- HTP is still vented due to oil leak last beam time, will be closed when?
- mCBM – to be closed this week

# What is needed until September

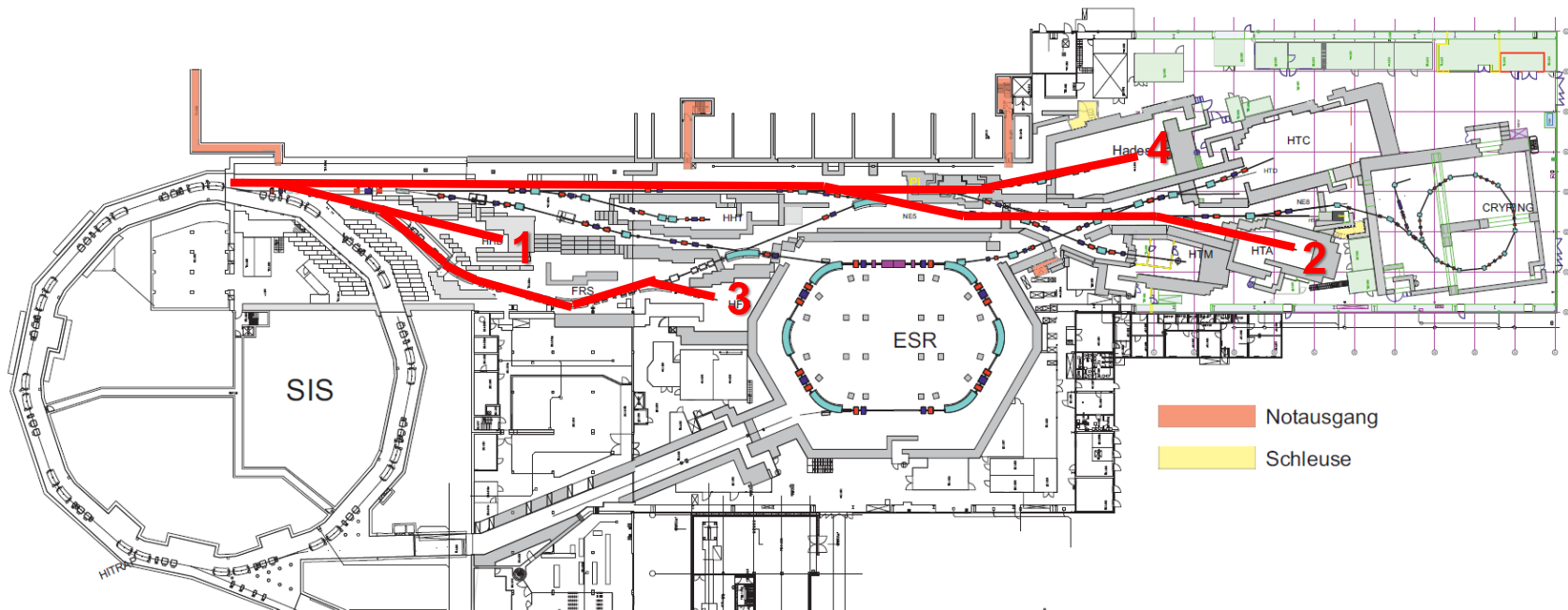

1. HHD – beam dump – settings ready
2. TH\_HTA – settings ready
3. FRS – preliminary settings ready, final settings – responsibility of FRS
4. HADES – needed for spill structure test (July 10) - settings ready

- June 4-8: commissioning without beam:
  - check all the equipment and instrumentation on these beamlines
  - constantly play the sequences: HHD, HFS, HADES, HTA
  - test MIRKO-WebDAV-trim, start and test achiving system, etc, etc
- June 9-10: operator training weekend (UNILAC)
- June 11-15: beam commissioning of SIS18, HHD will be used
- When beam is ready is SIS18:
  - start commission HFS
  - commission TH\_HTA when people are not working in HTA
  - commission HADES (cave closed for 2 days in last week of June)
  - alternatively use beam paths TH\_HTP and TP\_HTP to commission parts of the beam paths when caves remain open (tbc.)